

HOLLISTER

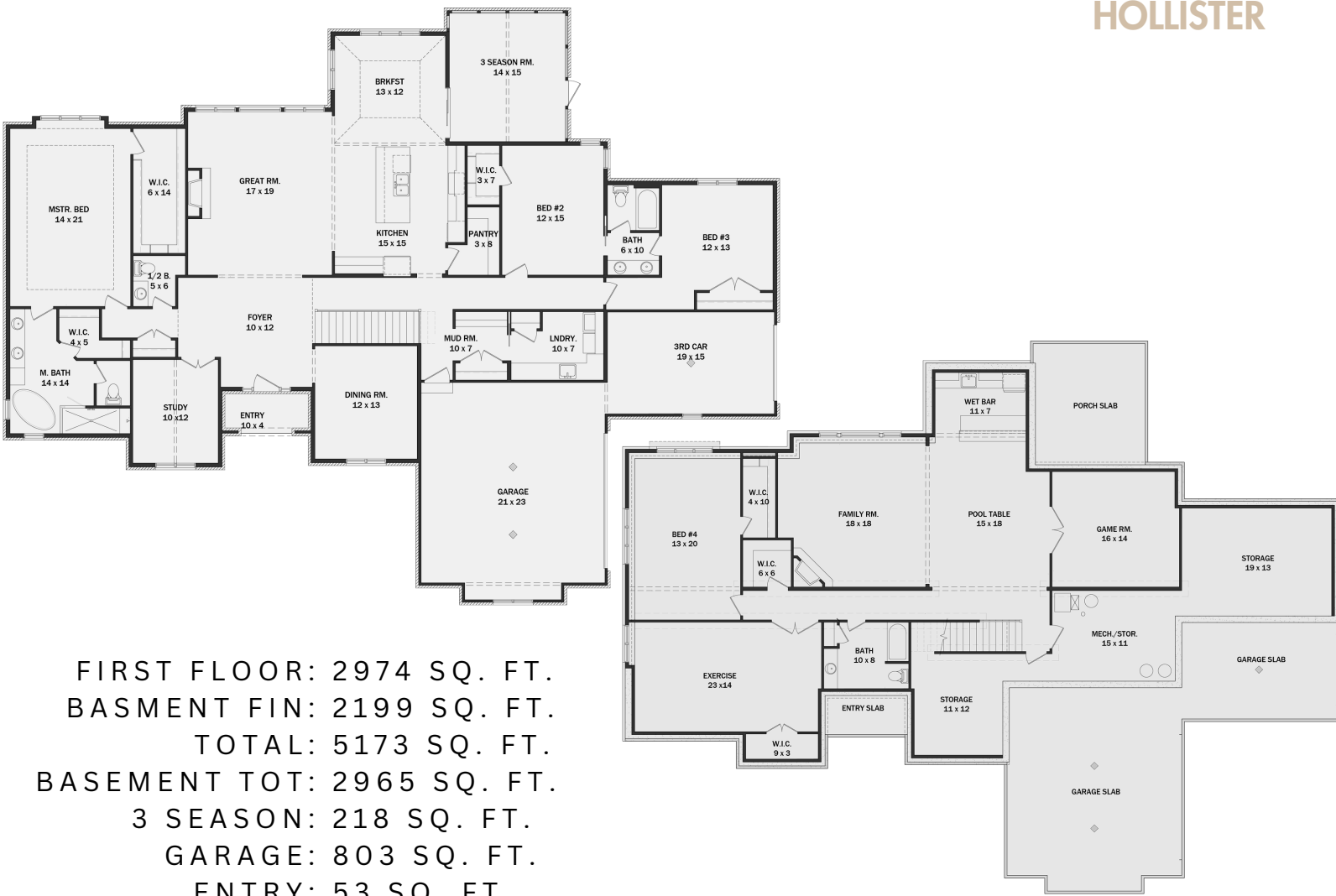

STARKS
Signature Homes



FIRST FLOOR: 2974 SQ. FT.
 BASMENT FIN: 2199 SQ. FT.
 TOTAL: 5173 SQ. FT.
 BASEMENT TOT: 2965 SQ. FT.
 3 SEASON: 218 SQ. FT.
 GARAGE: 803 SQ. FT.
 ENTRY: 53 SQ. FT.



4 BEDROOMS



3.5 BATHROOMS



3 CAR GARAGE



5173 SQ.FT

This expansive 5,173 square foot ranch-style home features four bedrooms and 3.5 bathrooms. The main level includes a grand foyer entry, a dining room, a family room with a fireplace, and a three-season room. The master suite boasts two walk-in closets. The partially finished basement host one of the bedrooms, a full bathroom, a wet bar, a family room with a fireplace, a game room, and an exercise room. A three-car garage provides ample storage and parking.



WWW.STARKSSIGNATUREHOMES.COM



3472 STELLHORN RD.
 FORT WAYNE, IN 46815



INFO@STARKSSIGNATUREHOMES.COM



260.557.1093